

# 拉桿長度計算

## THE CALCULATION OF DRAW TUBE LENGTH

### 中空拉桿製作 Manufacture of Draw Tube

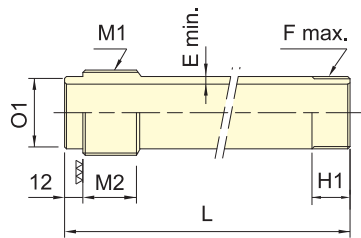

拉桿詳圖 Detail Draw Pipe

$$L = A + G2_{max.} + H - G1_{max.} + M2 + 12$$

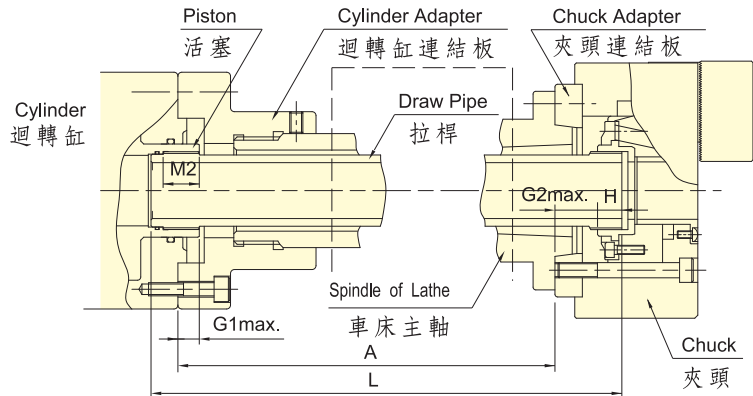

3H-04可搭配 TH-428  
註: 2H, 4H 之拉桿長度計算同 3H

保留規格修改的權利  
Subject to technical changes.

夾頭型式 Chuck type	迴轉缸型式 Cylinder type	G1 max.	H	M2	G2 max.	M1	H1	O1 (f7)	F max.	E min.	L			
3H-04A4	TH-536	15	14.5	25	31.5	M42x1.5	25	38 <sup>-0.025</sup> <sub>-0.050</sub>	M32x1.5	3.5	A+56+12			
3H-05A4			17		16				M40x1.5		A+43+12			
3H-06A5	TH-646	20	15	30	26	M55x2	50 <sup>-0.025</sup> <sub>-0.050</sub>	55 <sup>-0.030</sup> <sub>-0.060</sub>	M55x2	5	A+56+12			
3H-08A6	TH-852		16.5		31.5	M60x2			M60x2		A+58+12			
3H-10A6	TH-1075	25	20.5	35	33.5	M85x2	80 <sup>-0.030</sup> <sub>-0.060</sub>	85 <sup>-0.030</sup> <sub>-0.060</sub>	M85x2	5	A+64+12			
3H-10A8					26.5						26	M100x2	M100x2	A+57+12
3H-12A6	TH-1291	30	23	45	33	M130x2	95 <sup>-0.036</sup> <sub>-0.071</sub>	125 <sup>-0.043</sup> <sub>-0.083</sub>	M130x2	5	A+61+12			
3H-12A8					26						M100x2	M100x2	A+54+12	
3H-15A8	TH-1512	30	33	45	44	M130x2	95 <sup>-0.036</sup> <sub>-0.071</sub>	125 <sup>-0.043</sup> <sub>-0.083</sub>	M130x2	5	A+92+12			
3H-15A11					33						33	M130x2	M130x2	A+81+12
3H-18A11					33						33	M130x2	M130x2	A+81+12

夾頭型式 Chuck type	迴轉缸型式 Cylinder type	G1 max.	H	M2	G2 max.	M1	H1	O1 (f7)	F max.	E min.	L
3H-06BA5	TK-852	20	15	30	26	M60x2	25	55 <sup>-0.030</sup> <sub>-0.060</sub>	M60x2	5	A+51+12
3H-08BA6	TK-1068	25	16.5		31.5	M75x2	25	70 <sup>-0.030</sup> <sub>-0.060</sub>	M75x2		A+53+12
3H-10BA8	TK-1287	30	20.5	35	26.5	M100x2	30	95 <sup>-0.036</sup> <sub>-0.071</sub>	M95x2	5	A+52+12
3H-12BA11	TK-1511		23	30	M120x2	35	125 <sup>-0.043</sup> <sub>-0.083</sub>	M115x2	A+68+12		
3H-15BA15	TK-2416	35	33	45	38	M180x3	45	170 <sup>-0.043</sup> <sub>-0.083</sub>	M155x3	5	A+90+16
3H-18BA15									M175x3		
3H-21BA15									M190x3		
3H-24BA15			M215x3		A+102+16						
3H-24BA20									A+89+16		

# 拉桿長度計算

## THE CALCULATION OF DRAW BAR LENGTH

### 中實拉桿製作 Manufacture of Draw Bar

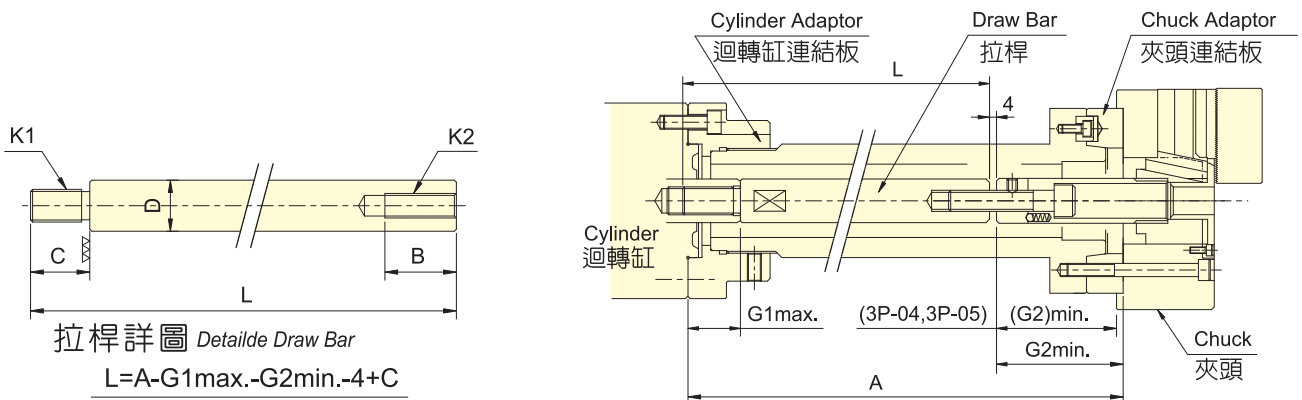

保留規格修改的權利  
Subject to technical changes.

夾頭型式 Chuck type	迴轉缸型式 Cylinder type	B	C	D	G1 max.	G2 min.	K1	K2	L
3P-04	RH-80/RK-75(N)/RA-130	30	25/30/20	25/30/25	45	3	M16x2/M20x2.5/M16x2	M10x1.5	A-27/A-22/A-32
3P-05	RH-80/RK-75(N)/RA-130	40	25/30/20	25/30/25	45	-6	M16x2/M20x2.5/M16x2	M12x1.75	A-18/A-13/A-23
3P-06	RH-100K/RK-100(N)/RA-170	40	30/30/25	30/30/25	45	81.5	M20x2.5/M20x2.5/M16x2	M16x2	A-101/A-101/A-106
3P-08	RH-125K/RK-125(N)/RA-220	40	40/40/30	35/35/30	50	106	M24x3/M24x3/M20x2.5	M20x2.5	A-120/A-120/A-130
3P-10	RH-125K/RK-125(N)/RA-220	40	40/40/30	35/35/30	50	133	M24x3/M24x3/M20x2.5	M20x2.5	A-147/A-147/A-157
3P-12	RH-150/RK-150(N)/RA-270	40	40/40/35	45/45/35	55	133	M30x3.5/M30x3.5/M24x3	M20x2.5	A-152/A-152/A-157
3P-15	RH-200/RK-200(N)	60	55	55	70	69	M36x4	M30x3.5	A-88
3P-18	RH-200/RK-200(N)	60	55	55	70	57	M36x4	M30x3.5	A-76
3P-21	RH-200/RK-200(N)	60	55	55	70	62	M36x4	M30x3.5	A-81
3P-24	RH-200/RK-200(N)	60	55	55	70	62	M36x4	M30x3.5	A-81

註: 2P型式之拉桿長度計算同3P型式

夾頭型式 Chuck type	迴轉缸型式 Cylinder type	B	C	D	G1 max.	G2 min.	K1	K2	L
3M-05	RK-75(N)	40	30	30	45	-2	M20x2.5	M12x1.75	A-17
3M-06	RK-100(N)	40	30	30	45	81.5	M20x2.5	M16x2	A-101
3M-08	RK-125(N)	40	40	35	50	106	M24x3.0	M20x2.5	A-120
3M-10	RK-125(N)	40	40	35	50	134	M24x3.0	M20x2.5	A-148
3M-12	RK-150(N)	50	40	45	55	40	M30x3.5	M24x3	A-59

註: 2M型式之拉桿長度計算同3M型式